

## Single Forward Mount

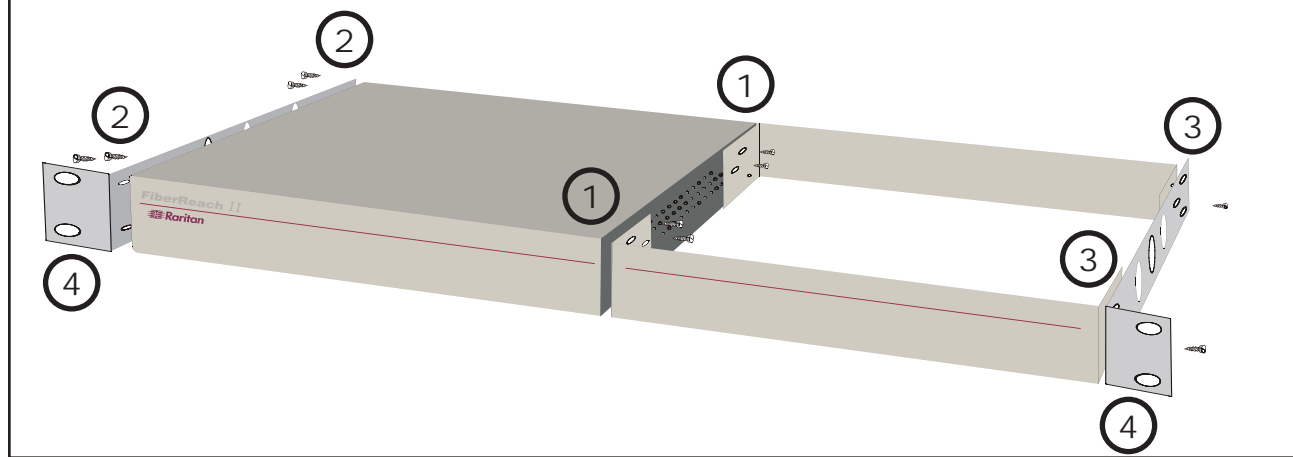

## Single Forward Mount

- 1 With the front of the FiberReach II unit facing you, secure each spacer bracket to the inner panel of the unit with two screws. The screws should be inserted into the oval-shaped holes of each spacer bracket.
- 2 Secure one side bracket to the opposite panel of the FiberReach II unit. Use two screws for the rear connection and two screws for the forward connection. Note that there are two threaded openings to use; the third opening, which is larger and is not threaded, is used for double mounting (described below).
- 3 Secure the other side bracket to the opposite ends of the spacer brackets. Use one screw for the rear connection and one screw for the forward connection. Note that there is only one threaded opening on either end.
- 4 Secure the entire assembly to a rack using two large rack screws (not included).

## Double Forward Mount

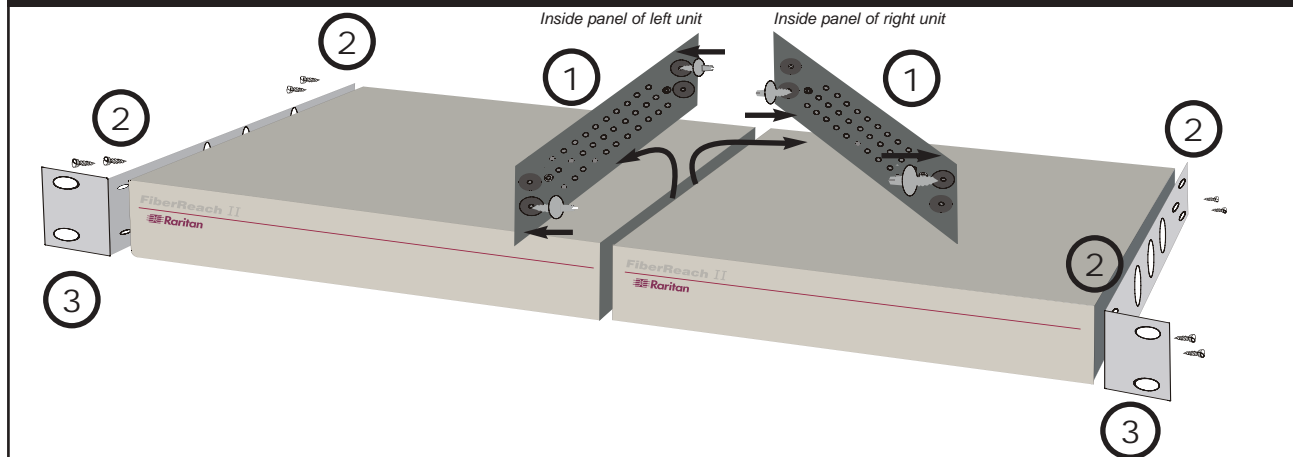

## Double Forward Mount

- 1 With the fronts of both FiberReach II units facing you, turn the unit on your left so that the inside panel faces you. Screw one dual-ended disk screw into the threaded opening within the indented circle on either end of the panel. Now turn the FiberReach II unit on your right so that the inside panel faces you, and once again, screw one dual-ended disk screw into the threaded opening within the indented circle on either end of the panel. With the fronts of both units facing you, fit the non-threaded extensions of each dual-ended disk screw into the openings in the opposite inside panel so that the units fit together.
- 2 Secure one side bracket to each outside panel of the FiberReach II units. Use two screws for the rear connection and two screws for the forward connection.
- 3 Secure the entire assembly to a rack using two large rack screws (not included). Remember to support the center connection of the two units until the assembly is securely fastened to the rack.

## Single Reverse Mount

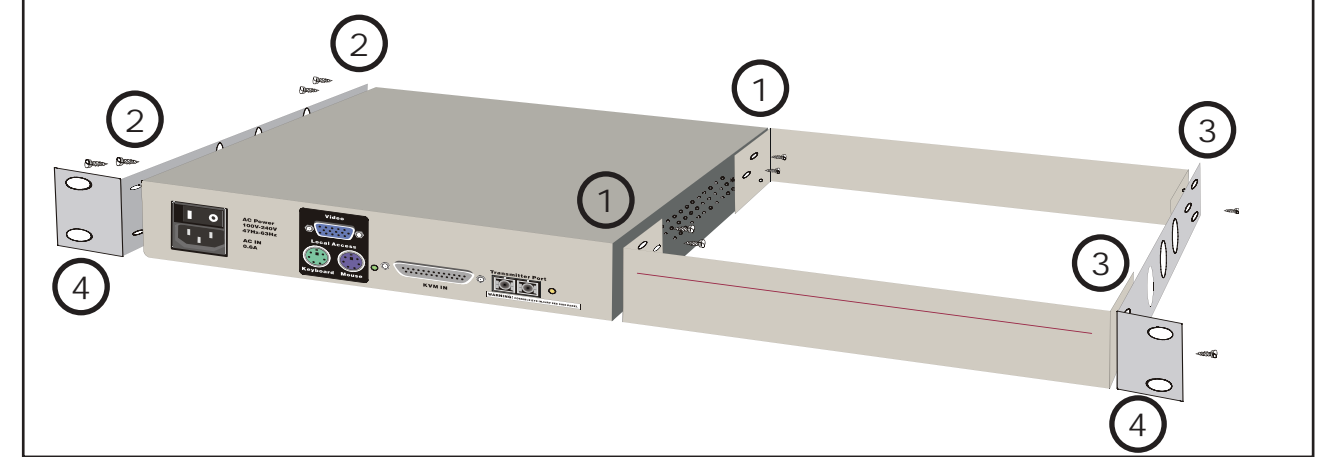

## Single Reverse Mount

- 1 With the back of the FiberReach II unit facing you, secure each spacer bracket to the inner panel of the unit with two screws. The screws should be inserted into the oval-shaped holes of each spacer bracket.
- 2 Secure one side bracket to the opposite panel of the FiberReach II unit. Use two screws for the rear connection and two screws for the forward connection. Note that there are two threaded openings to use; the third opening, which is larger and is not threaded, is used for double mounting (described below).
- 3 Secure the other side bracket to the opposite ends of the spacer brackets. Use one screw for the rear connection and one screw for the forward connection. Note that there is only one threaded opening on either end.
- 4 Secure the entire assembly to a rack using two large rack screws (not included).

## Double Reverse Mount

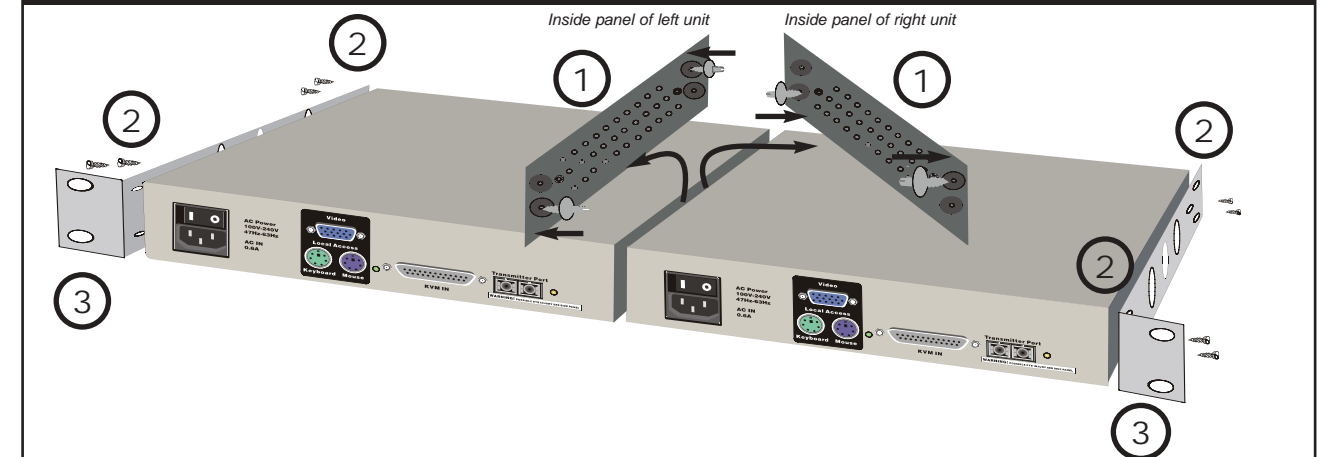

## Double Reverse Mount

- 1 With the backs of both FiberReach II units facing you, turn the unit on your left so that the inside panel faces you. Screw one dual-ended disk screw into the threaded opening within the indented circle on either end of the panel. Now turn the FiberReach II unit on your right so that the inside panel faces you, and once again, screw one dual-ended disk screw into the threaded opening within the indented circle on either end of the panel. With the backs of both units facing you, fit the non-threaded extensions of each dual-ended disk screw into the openings in the opposite inside panel so that the units fit together.
- 2 Secure one side bracket to each outside panel of the FiberReach II units. Use two screws for the rear connection and two screws for the forward connection.
- 3 Secure the entire assembly to a rack using two large rack screws (not included). Remember to support the center connection of the two units until the assembly is securely fastened to the rack.